

Notes:

1. Material: Phosphor bronze, JIS C5191H, HV 200°±5°
2. Applicable wire: AWG#28~#22
2. Along any portion of strip, max allowable camber is 0.04mm Per 1000mm length. And max allowable twist is 45° Per 1000mm length.
3. All corners and radians have a maximum radius of 0.1mm unless otherwise specified.

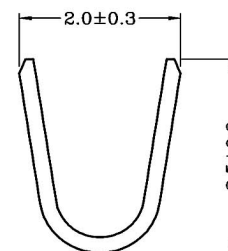

SEC:A-A

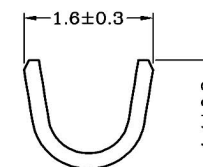

SEC:B-B

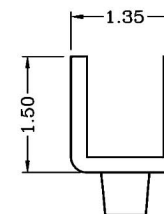

SEC:C-C

RoHS Compliant		<b>HSM</b> 玄茂科技股份有限公司		HSUAN MAO TECHNOLOGY CO., LTD.	
APPD. 核准	Betty	SCALE 比例 参考	UNIT 單位 M M	PAGE 張數 1 OF 1	PART NAME 品名 2.0mm TERMINAL MATERIAL:PHOSPHOR BRONZE TIN PLATED SUITABLE AWG22~28 ROHS
DWG. 製圖	Betty				
DATE 制表日	2013/09/26				PART NO. 料號 T2013-TPJ00000R
		GENERAL TOLERANCE			
		XX ±0.40			
		X ±0.30			
		X ±0.25		X' ± 2°	
		XX ±0.16		X' ± 1°	
		SIZE 紙張尺寸		A 4	
		REV. 版次		A	