

### ELECTRICAL CHARACTERISTICS

Contact Current Rating: 5Amperes.  
 Dielectric Withstanding Voltage: AC 500V at sea level.  
 Insulation Resistance: 1000Megohms Min.  
 Contact Resistance: 25Milliohms Max.  
 Operation Temperature: -55°C to +105°C.

### Material

Machine Pin :Copper Alloy.  
 Insulator:PBT. [Select PA6T /LCP /PA9T]  
 Shell: SPCC.  
 Screw: Copper Alloy.

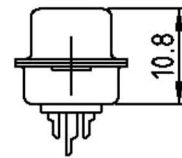
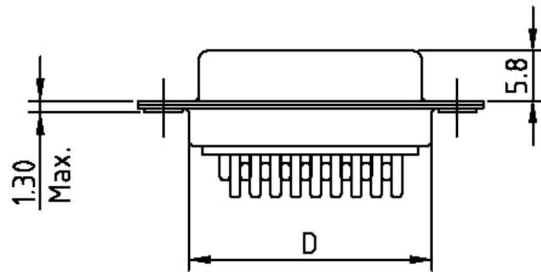

### Note:

No.	A	B	C	D	E	F
15	16.33	24.99	30.81	19.23	2.29	1.145
26	24.66	33.32	39.14	27.56	2.29	1.145
44	38.38	47.04	53.04	41.28	2.29	1.145
62	54.84	63.50	69.32	57.33	2.41	1.205

RoHS Compliant		<b>HSM</b> 玄茂科技股份有限公司 <b>HSUAN MAO TECHNOLOGY CO., LTD.</b>	
APPD. 核准 HELEN		TOLERANCE X ± 0.30 XX ± 0.25 XXX ± 0.150 Ang. ± 2°	PART NAME 品名 HIGH DENSITY D-SUB SOLDER TYPE MACHINED PIN XXP FEMALE THROUGH HOLE TIN SHELL ROHS
DWG. 製圖 ABBY	SCALE 比例 參考	UNIT 單位 MM	PART NO. 料號 C0574-XXFAATXXXR
DATE 制表日 2011/11/25	PAGE 張數 1 OF 1	SIZE. 紙張尺寸 A 4 REV. 版次 A	