

MATERIALS AND FINISH
 SHELL : STEEL MATERIAL, FRONT SHELL TIN FINISHED
 BACK SHELL TIN FINISHED
 DIMPLES ON PLUG ONLY
 INSULATOR : PBT THERMOPLASTIC, 30% GLASS FILLED,
 UL 94V-0 RATED, BLACK COLOR
 SIGNAL CONTACT : COPPER ALLOY, FULL GOLD FLASH
 COAXIAL CONTACT : COPPER ALLOY, FULL GOLD FLASH

ELECTRICAL CHARACTERISTICS
 SIGNAL CONTACT CURRENT RATING : 5.0 AMPS
 SIGNAL CONTACT RESISTANCE : 2.7 mΩ MAX.
 COAXIAL CONTACT IMPEDANCE : 50 Ω
 DIELECTRIC WITHSTANDING VOLTAGE : 1000 V AC FOR 1 MINUTE
 INSULATION RESISTANCE : 10⁷MΩ MIN.
 TEMPERATURE RATING : -55°C ~ +125°C

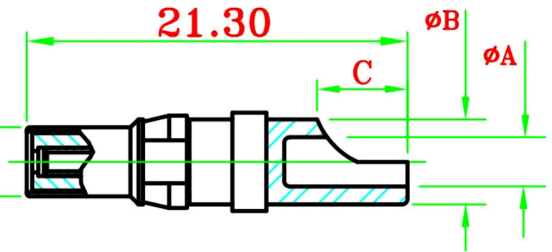

Power Type

Current Rating	Dimension		
	φA	φB	C
40 Amps	φ4.6	φ5.5	5.5

RoHS Compliant	HSM 玄茂科技股份有限公司 HSUAN MAO TECHNOLOGY CO., LTD.		
APPD. 核准 BETTY	 TOLERANCE 容許公差 SCALE 比例 參考 UNIT 單位 M M PAGE 張數 1 OF 1	PART NAME 品名 D-SUB COAXIAL SOLDER TYPE 25W3 MALE 40Amps RIVET 4-40UNC 4.0mm OPEN NUTS ON READ SHELL WITH POWER CONTACT GOLD PLATING BLACK INSULATOR ROHS	PART NO. 料號 C0590-HMDDXG0BR
DWG. 製圖 BETTY			
DATE 制表日 2011/03/09	REV. 版次 A		