

**Coaxial Type**

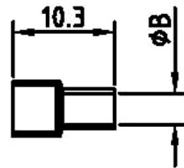
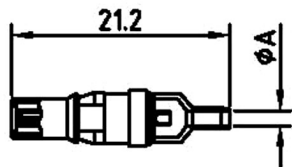

PART NO.	Current Impedance	Dimension	
		φA	φB
01	50Ω	φ1.6	φ3.2
02	75Ω	φ3.0	φ4.0

**① ELECTRICAL CHARACTERISTICS**

Dielectric withstanding Voltage: 1000VAC for one minute at sea level.  
 Insulation Resistance: >1000MΩ  
 High power contact resistance: <27mΩ  
 Connector mating and unmating force: 17.0 kgf max.  
 Operating Temperature: -55°C to +105°C

**② MATERIAL**

Insulator: PBT.  
 Power Contact: Copper Alloy.  
 Shell: SPCC.

APPD. 核准 Betty		TOLERANCE 容許公差	PART NAME 品名
DWG. 製圖 Yumi		SCALE 比例 參考	
DATE 制表日 2008/02/27	UNIT 單位 M M	SIZE 紙張尺寸 A 4	D-SUB COAXIAL SOLDER TYPE 17W2
PAGE 張數 1 OF 1	REV. 版次 A		MALE THROUGH HOLE WITH SIGNAL
			CONTACT BLACK INSULATOR ROHS LOW-LEAD
			PART NO. 料號 C0590-JMXAX0GBR

**HSM 玄茂科技股份有限公司**  
**HSUAN MAO TECHNOLOGY CO., LTD.**