

1 2 3 4 5 6 7 8

A  
B  
C  
D  
E  
F  
G  
H

A  
B  
C  
D  
E  
F  
G  
H

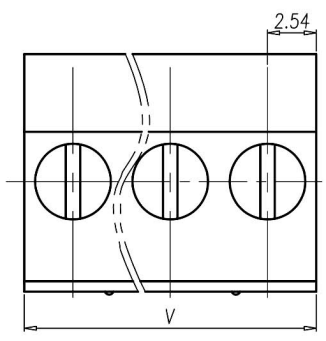

5	BASE HOUSING	PA66	UL94-V0 GREEN
4	CLAMP	COPPER ALLOY	Tin PLATED
3	SCREW	STEEL	Zn Plated
2	WIRE CAGE	STEEL	Zn Plated
1	TOP HOUSING	PA66	UL94-V0 GREEN
ITEM	NAME OF PART	MATERIAL	NOTES

NOTES 1:

UL Standard :

- Rating: 300V 15A  
PITCH: 5.08mm
- Insulation Withstands Voltage:  
AC 4000V at 1 minute
- Using Temperature Range:  
-40°C~+115°C
- Screw Torque Value: 0.5N·m
- Suitable Electric Wire: AWG 28~12(sol)  
AWG 30~12(str)

IEC Standard :

- Rating: 600V 18A
- Rate Impluse Voltage: 4000V
- Insulation Resistance:  
500M Ω or more at DC500V
- Material Group : I
- Pollution Degree : 2
- Overvoltage Category: II
- Using Temperature Range:  
-40°C~+110°C
- Screw Torque Value: 0.5N·m
- Suitable Electric Wire: 0.2~4mm<sup>2</sup> (sol)  
0.2~2.5mm<sup>2</sup> (str)

NOTES 2:

- RoHS Compliance
- Strip Length: 7~8mm

Total Pitch Tolerances		Normal Dimension Tolerances	
0~30	±0.20	0~30	±0.25
over 30~53	±0.25	over 30~53	±0.30
over 53~70	±0.30	over 53~70	±0.35
over 70~90	±0.35	over 70~90	±0.44
over 90~115	±0.44	over 90~115	±0.55
over 115~150	±0.55	over 115~150	±0.70
over 150~200	±0.70	over 150~200	±0.85
over 200~250	±0.85	over 200~250	±1.00
over 250~320	±1.00	over 250~320	±1.20

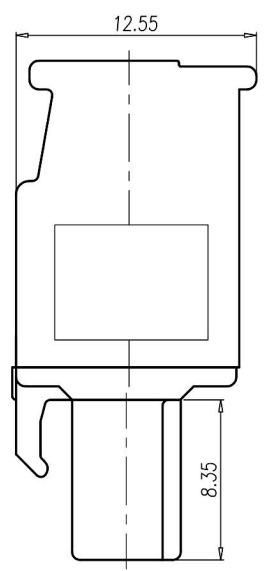
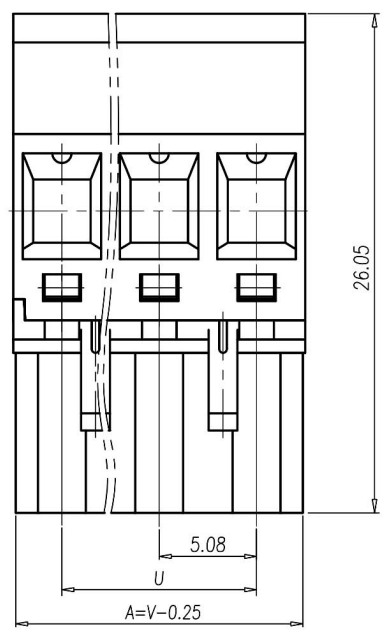

P	2	3	4	5	6	7	8	9	10	11	12	13	14	15	16
U	5.08	10.16	15.24	20.32	25.40	30.48	35.56	40.64	45.72	50.80	55.88	60.96	66.04	71.12	76.20
V	10.16	15.24	20.32	25.40	30.48	35.56	40.64	45.72	50.80	55.88	60.96	66.04	71.12	76.20	81.28
P	17	18	19	20	21	22	23	24	25	26					
U	81.28	86.36	91.44	96.52	101.6	106.68	111.76	116.84	121.92	127.00					
V	86.36	91.44	96.52	101.6	106.68	111.76	116.84	121.92	127.00	132.08					

APPD. 核准	SCALE 比例 参考	PART NAME 品名 5.08mm TERMINAL BLOCK XXPIN WIRE CAGE TYPE SUITABLE FOR 12~30AWG TIN PLATED GREEN INSULATOR SCREWS ZINC PLATING WITHOUT EARS(SCREWS HOLE) ROHS	
			RoHS Compliant
DWG. 製圖	UNIT 單位	SIZE. 紙張尺寸	PART NO. 料號
DATE 制表日	PAGE 張數	REV. 版次	
Betty		M M A 4	C0918-XXA3TE00R
2017/03/03		1 OF 1	

1 2 3 4 5 6 7 8