

RECOMMENDED P. C. B LAYOUT

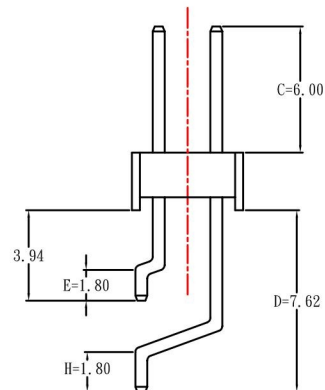
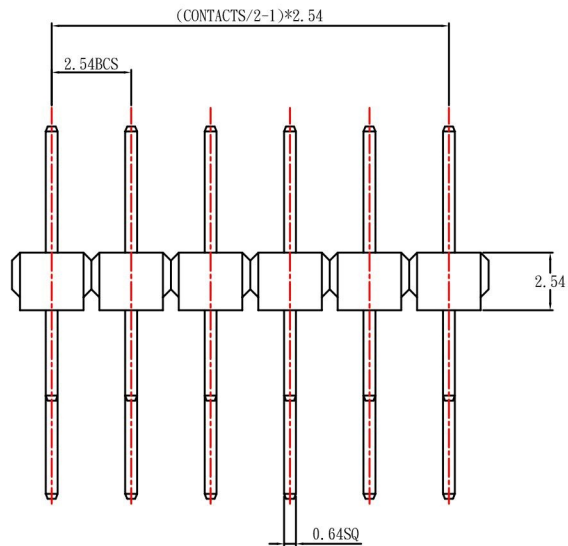

PACKING:(OPTION)

T=W/O Locating Peg (Tube packing)

P=W/O Locating Peg (PAD+Tube packing)

C=W/O Locating Peg (PAD+Reel packing)

|          |      |
|----------|------|
| CONTACTS | 2*21 |
| 2*2      | 2*22 |
| 2*3      | 2*23 |
| 2*4      | 2*24 |
| 2*5      | 2*25 |
| 2*6      | 2*26 |
| 2*7      | 2*27 |
| 2*8      | 2*28 |
| 2*9      | 2*29 |
| 2*10     | 2*30 |
| 2*11     | 2*31 |
| 2*12     | 2*32 |
| 2*13     | 2*33 |
| 2*14     | 2*34 |
| 2*15     | 2*35 |
| 2*16     | 2*36 |
| 2*17     | 2*37 |
| 2*18     | 2*38 |
| 2*19     | 2*39 |
| 2*20     | 2*40 |

**MATERIAL**

HOUSING: THERMOPLASTIC UL94V-0

CONTACT: COPPER ALLOYS

**SPECIFICATION**

CURRENT: 3A

OPERATING TEMPERATURE: -55°C TO +105°C

CONTACT RESISTANCE: 20MILLIOHMS MAX

INSULATION RESISTANCE: 1000 MEGAOHMS MIN

WITHSTANDING VOLTAGE: AC 1000V RMS



**HSM** 玄茂科技股份有限公司  
HSUAN MAO TECHNOLOGY CO., LTD.

|                    |  |  |   |
|--------------------|--|--|---|
| APPD.<br>KAREN     | SCALE<br>参考<br>UNIT<br>M M<br>PAGE<br>1 OF 1 | TOLERANCE<br>.0 ±0.38<br>.00 ±0.25<br>ANG. ±5° | PART NAME 品名<br>2.54mm PIN HEADER DUAL ROW HORIZONTAL SMT TYPE H=6.1mm<br>2*XXP GOLD FLASH PLATING (C:6.0/D:7.62/E:1.8/H:1.8mm)<br>WITHOUT LOCATING PEGS ROHS |
| DWG.<br>Helen      |  | SIZE.<br>A 4                                   |   |
| DATE<br>2015/04/21 | REV.<br>A                                    | PART NO.<br>料號 C2105-XXBDGJA(T,P,C)R           |   |