

CONTACTS	2X21
2X2	2X22
2X3	2X23
2X4	2X24
2X5	2X25
2X6	2X26
2X7	2X27
2X8	2X28
2X9	2X29
2X10	2X30
2X11	2X31
2X12	2X32
2X13	2X33
2X14	2X34
2X15	2X35
2X16	2X36
2X17	2X37
2X18	2X38
2X19	2X39
2X20	2X40

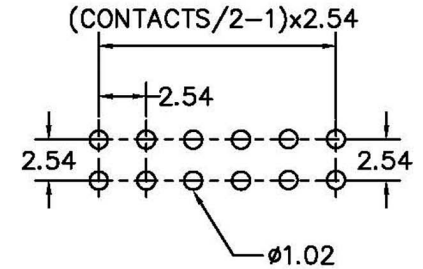

RECOMMENDED P.C.B LAYOUT

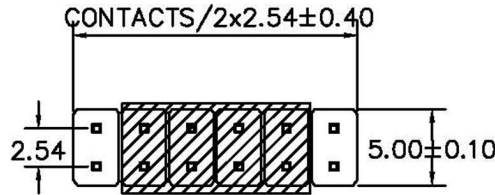
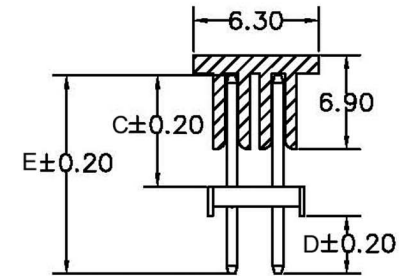
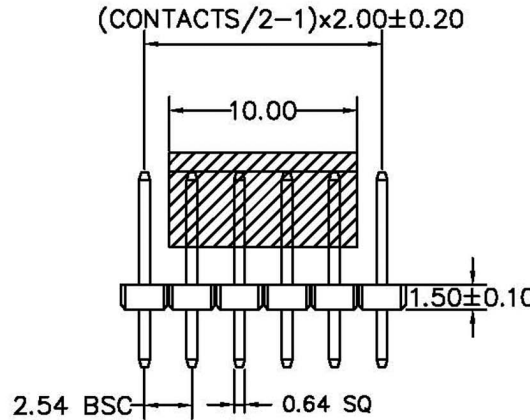

E: 13.10 mm C: 2.80 mm D: 8.80 mm

MATERIAL

HOUSING : NYLON 6T,UL94V-0  
 CONTACT : COPPER ALLOYS  
 PLATED : GOLD-FLASH  
 COLOR : NATURAL(BLACK)

SPECIFICATION

CURRENT: 3A  
 OPERATING TEMPERATURE: -55°C TO +105°C  
 CONTACT RESISTANCE : 20 MILLIOHMS MAX  
 INSULATION RESISTANCE : 1000 MEGAOHMS MIN  
 WITHSTANDING VOLTAGE : AC 1000V RMS

RoHS Compliant		<b>玄茂科技股份有限公司</b> <b>HSUAN MAO TECHNOLOGY CO., LTD.</b>	
APPD. 核准 Hedy	SCALE 比例 参考	TOLERANCE 容許公差 0=±0.38 .00=±0.25 ANG=±15°	PART NAME 品名 2.54mm PIN HEADER DUAL ROW H=1.5mm 2XXXP STRAIGHT TYPE FULL GOLD PLATING (C=2.8mm D=8.8mm) MATERIAL:NYLON 6T ROHS SOLDERING TEMPERATURE 260°C 5 SECONDS
DWG. 製圖 Yumi	UNIT 單位 MM	SIZE 紙張尺寸 A 4	PART NO. 料號 C2106-XXBSGECXR
DATE 制表日 2011/09/23	PAGE 張數 1 OF 1	REV. 版次 A	