

Cir- cuits	Dimension (mm)
	L1
3	5.08
4	7.62
5	10.16
6	12.70
7	15.24
8	17.78
9	20.32
10	22.86
11	25.40
12	27.94
13	30.48
14	33.02
15	35.56
16	38.10
17	40.64
18	43.18
19	45.72
20	48.26
21	50.80
22	53.34
23	55.88
24	58.42
25	60.96
26	63.50
27	66.04
28	68.58
29	71.12
30	73.66
31	76.20
32	78.74
33	81.28
34	83.82
35	86.36
36	88.90
37	91.44
38	93.98
39	96.52
40	99.06

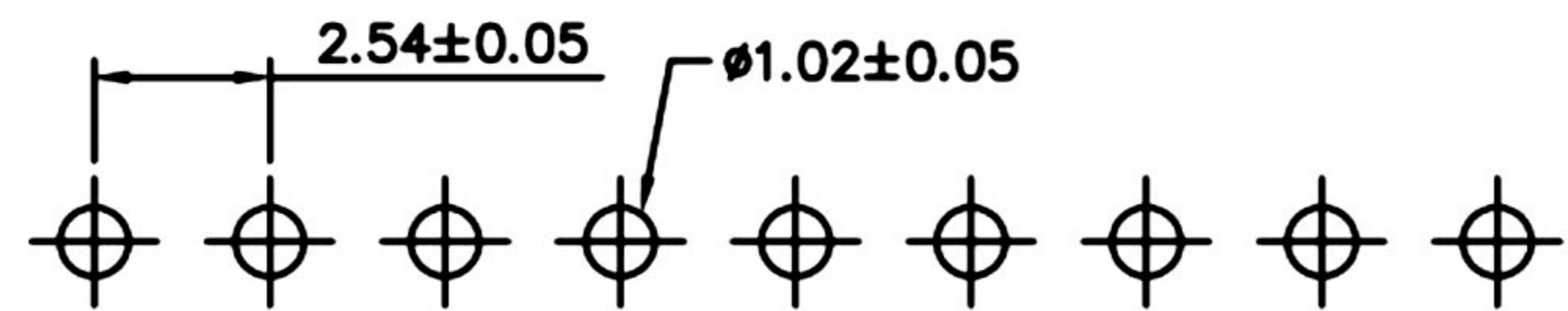
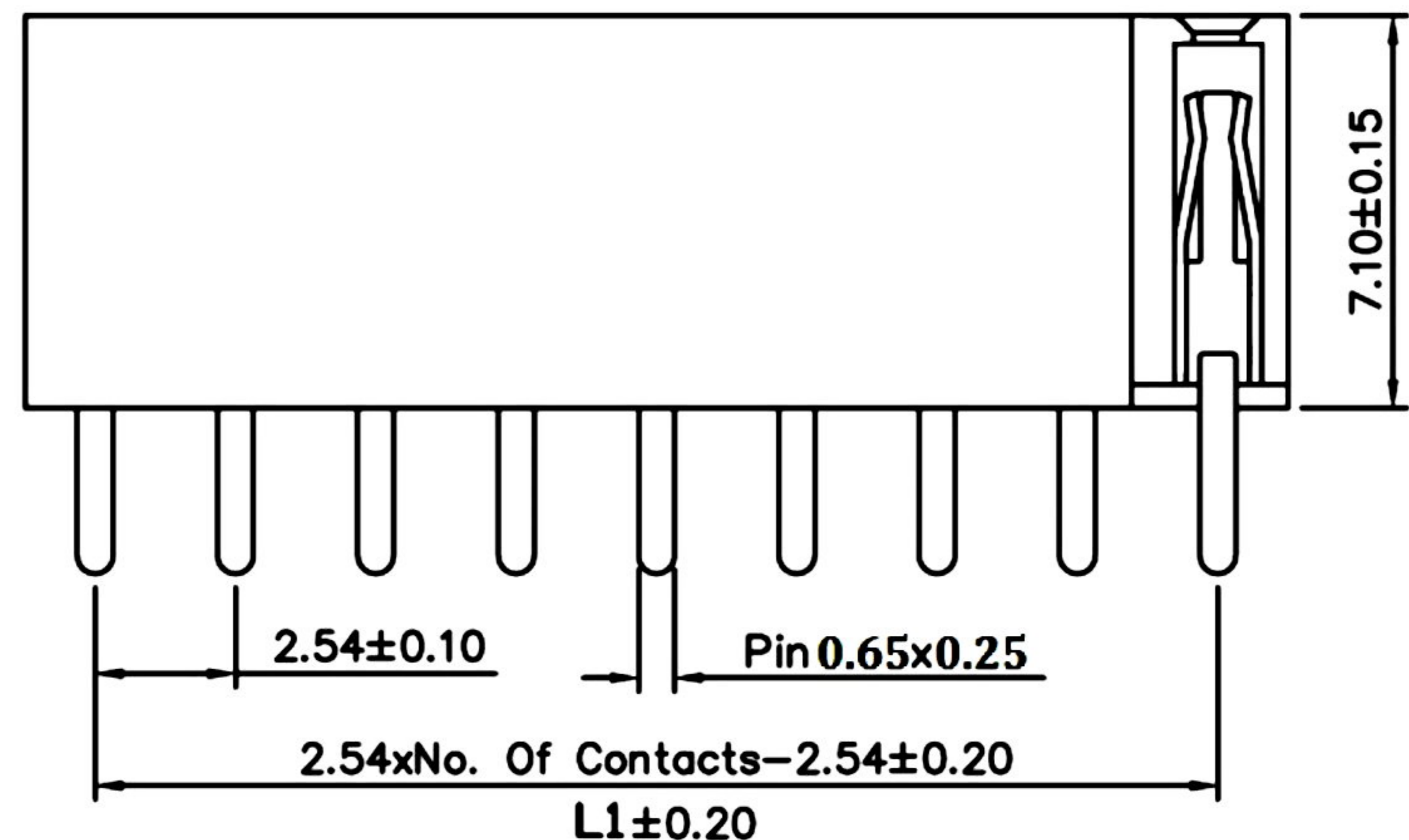
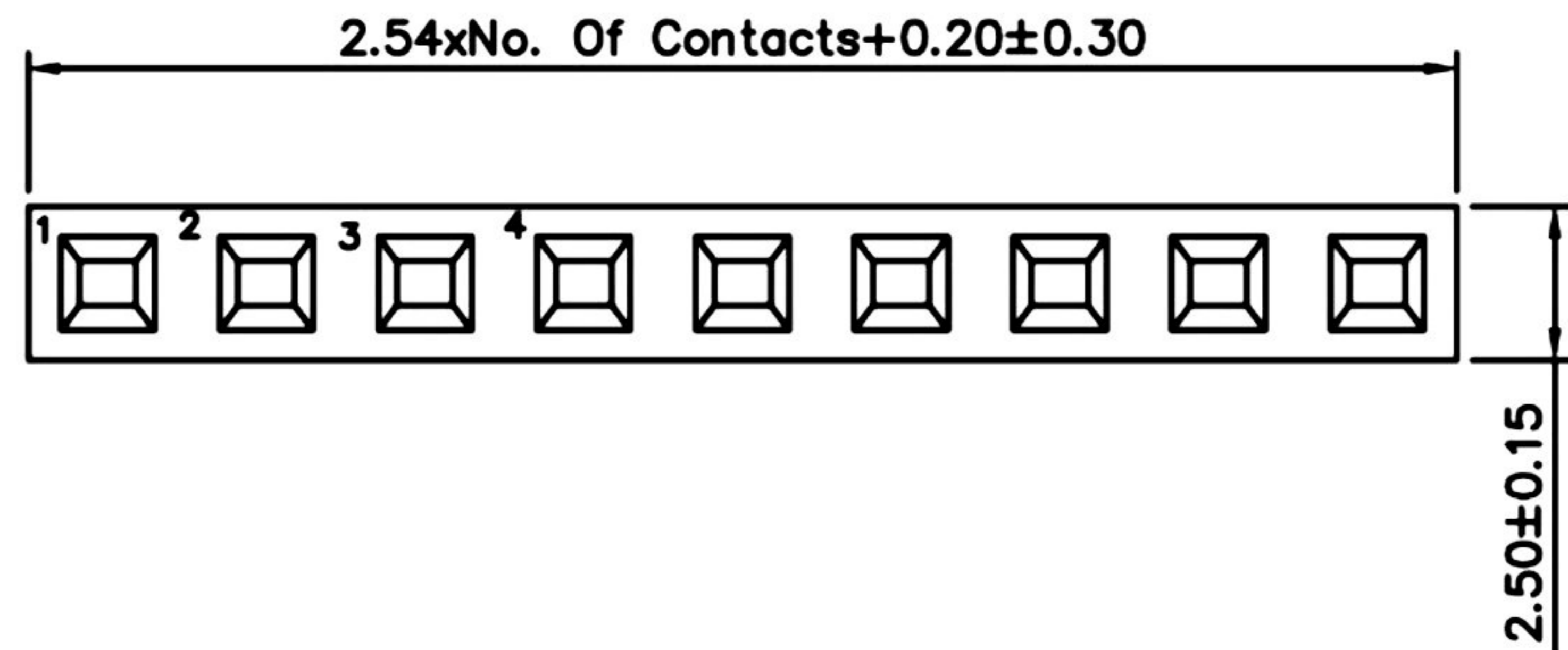

Recommended P.C.Board Hole Layout

SPECIFICATIONS

Current Rating: 3 Amp
 Insulator Resistance: 5000 Megohms Min.
 Dielectric Withstanding: AC 500V
 Operating Temperature: -40°C ~ +105°C
 Max. Processing Temp.: 230°C For 30~60 Seconds
 (260°C For 10 Seconds)
 Contact: Phosphor Bronze
 Insulation Material: Polyester, UL 94V-0
 Nylon 6T

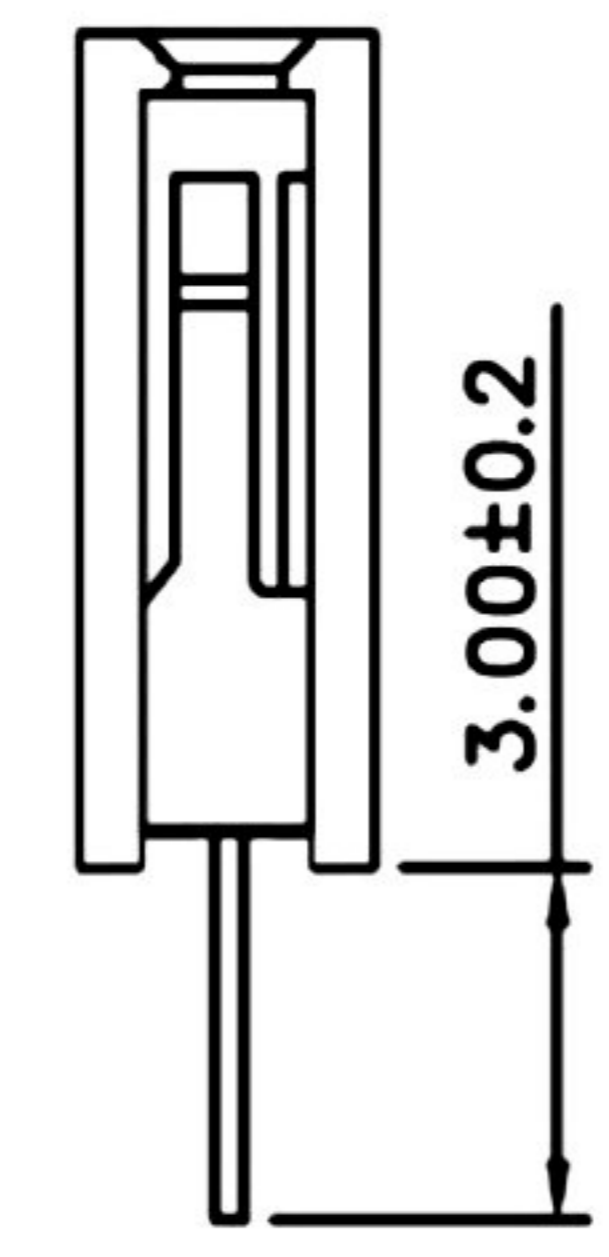

RoHS Compliant		HSM 玄茂科技股份有限公司 HSUAN MAO TECHNOLOGY CO., LTD.	
APPD. 核准 HELEN	SCALE 比例 參考	TOLERANCE 容許公差 .X ±0.38 .XX ±0.25 .XXX ±0.12	PART NAME 品名 2.54mm FEMALE HEADER SINGLE ROW H:7.1mm 1XXXP STRAIGHT TYPE ROHS
DWG. 製圖 ABBY	UNIT 單位 MM	SIZE. 紙張尺寸 A4	PART NO. 料號 C2826-XXASXH00R
DATE 制表日 2020/12/21	PAGE 張數 1 OF 1	REV. 版次 C	