

RECOMMENDED P.C.B LAYOUT

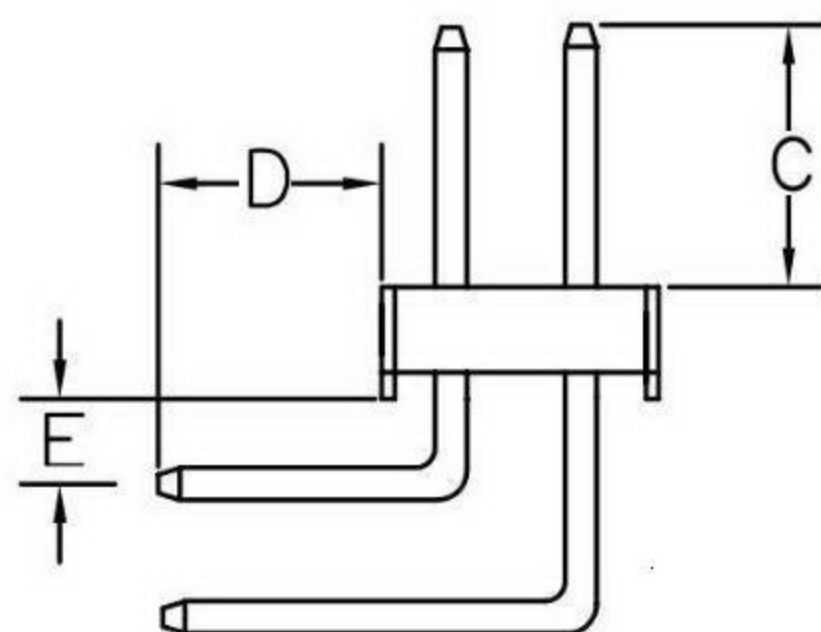
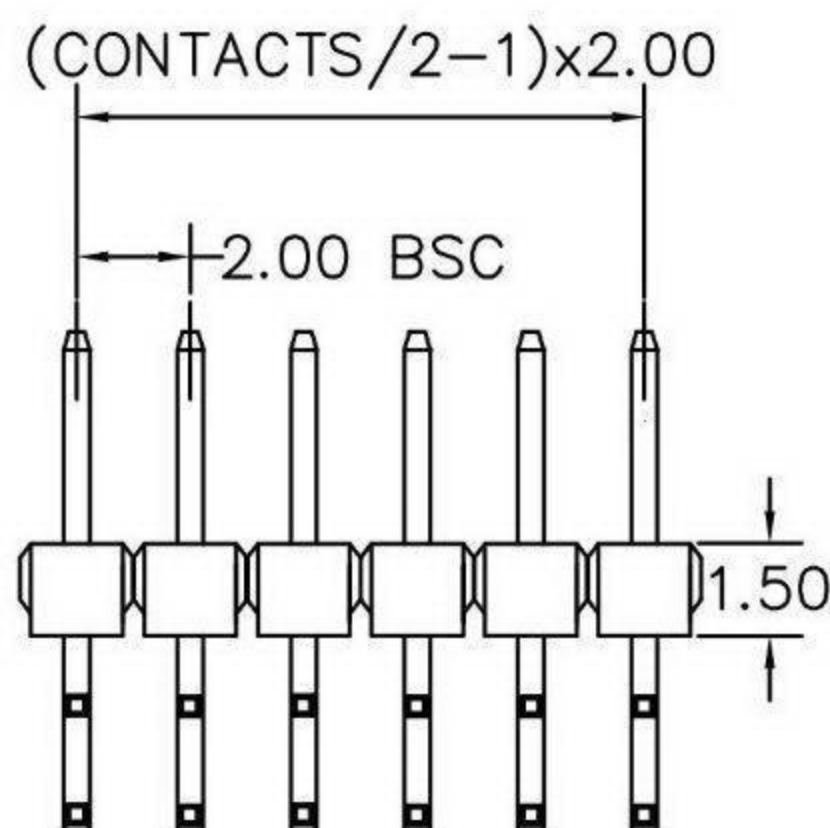

C: 3.9 mm D: 2.8 mm E: 1.1 mm

CONTACTS	2X21
2X2	2X22
2X3	2X23
2X4	2X24
2X5	2X25
2X6	2X26
2X7	2X27
2X8	2X28
2X9	2X29
2X10	2X30
2X11	2X31
2X12	2X32
2X13	2X33
2X14	2X34
2X15	2X35
2X16	2X36
2X17	2X37
2X18	2X38
2X19	2X39
2X20	2X40

MATERIAL

HOUSING : THERMOPLASTIC UL94V-0 NYLON 6T
CONTACT : COPPER ALLOYS

SPECIFICATION

CURRENT: 1A
OPERATING TEMPERATURE: -55°C TO +105°C
CONTACT RESISTANCE : 20 MILLIOHMS MAX
INSULATION RESISTANCE : 5000 MEGAOHMS MIN
DIELECTRIC STRENGTH : 1000 VAC MIN

RoHS Compliant		HSM 玄茂科技股份有限公司 HSUAN MAO TECHNOLOGY CO., LTD.	
APPD. 核准 BETTY		TOLERANCE 容許公差 .0 ± 0.38 .00 ± 0.25 ANG. ± 5°	PART NAME 品名 2.0mm PIN HEADER DUAL ROW 2X??P RIGHT ANGLE TYPE H=1.5mm FULL GOLD PLATING ROHS (C=3.9mm D=2.8mm E=1.1mm)
DWG. 製圖 KAREN	SCALE 比例 參考	UNIT 單位 MM	SIZE 紙張尺寸 A4
DATE 制表日 2014/05/20	PAGE 張數 1 OF 1	REV. 版本 A	PART NO. 料號 C6215-XXBRGAR0R