

Features:

- 4 ~ 16 circuits available
- Plastic material: LCP
- Contact: High conductivity copper
- Finished: Tin-plated 100u"over nickel 30u"
- .025"(0.64mm) square pin

Specification:

- Current rating: 4.5A AC, DC
- Voltage rating: 250V AC, DC
- Insulation resistance: 1000mΩ Min
- Contact resistance: 10mΩ Max.
- Dielectric withstanding voltage: 1500V AC/minute
- Ambient temperature range: -40°C ~ 105°C

Dimensional Information (mm)

Circuits	Dim. A	Dim. B
N	1.25 x N - 2.5	1.25 x N + 0.94

&& N = 4 ~ 16

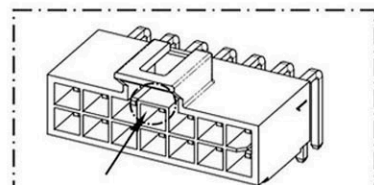

6, 10, 14 poles

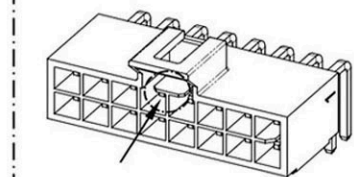

4, 8, 12, 16 poles

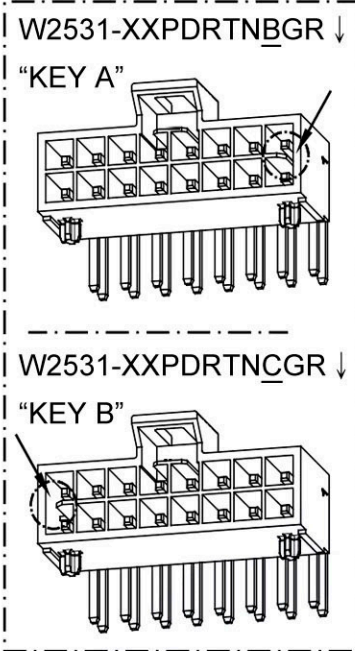

W2531-XXPDRTNBGR ↓

"KEY A"

W2531-XXPDRTNCGR ↓

"KEY B"

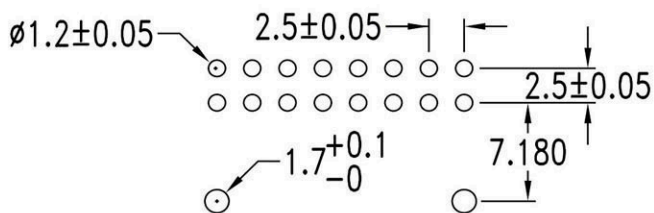
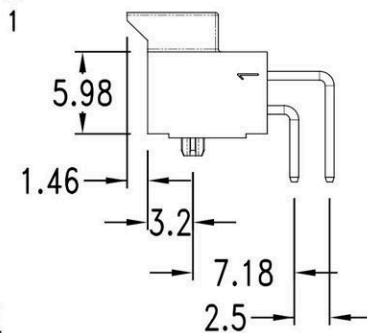
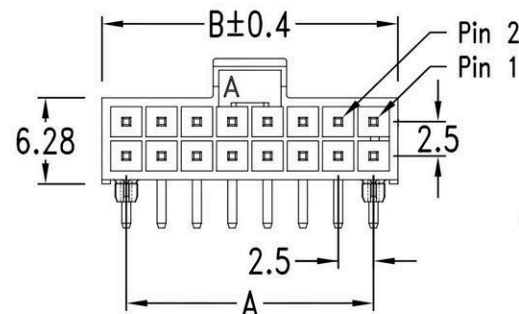
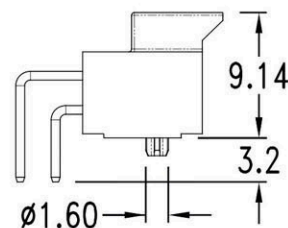
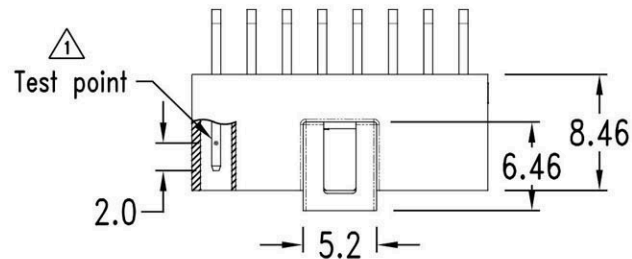

Recommended P. C. B. hole dimension
Recommended P. C. B. thickness 1.6 ~ 2.4mm

RoHS Compliant		HSM 玄茂科技股份有限公司 HSUAN MAO TECHNOLOGY CO., LTD.	
APPD. 核准	SCALE 比例 参考	TOLERANCE 容許公差 0 ± 0.40 .00 ± 0.25 ANG. ± 3°	PART NAME 品名 Nano-Fit 2.5mm Wafer Dual Row 2X??Pin 90° Tin Plating Material:LCP Bag Packing ROHS
DWG. 製圖 Helen	UNIT 單位 MM	SIZE 紙張尺寸 A4	PART NO. W2531-XXPDRTNXGR
DATE 制表日 2019/9/27	PAGE 張數 1 OF 1	REV. 版本 A	料號