

Dimensional Information (mm)

Circuits	Dim. A	Dim. B	Circuits	Dim. A	Dim. B	Circuits	Dim. A	Dim. B	Circuits	Dim. A	Dim. B	Circuits	Dim. A	Dim. B	Circuits	Dim. A	Dim. B
			6	6.0	15.0	10	12.0	21.0	14	18.0	27.0	18	24.0	33.0	22	30.0	39.0
4	3.0	12.0	8	9.0	18.0	12	15.0	24.0	16	21.0	30.0	20	27.0	36.0	24	33.0	42.0

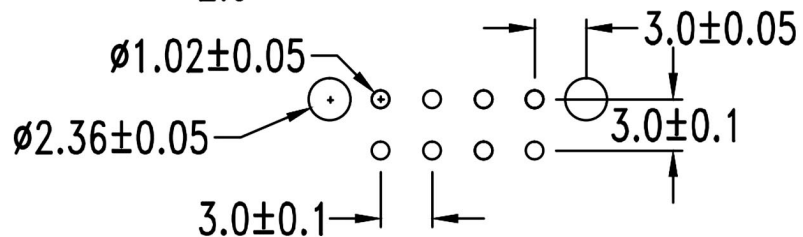
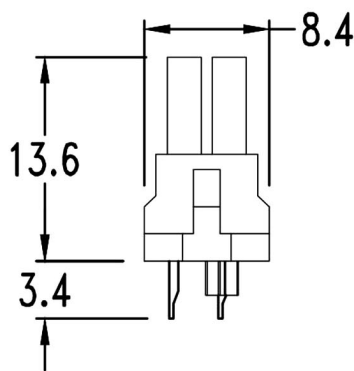
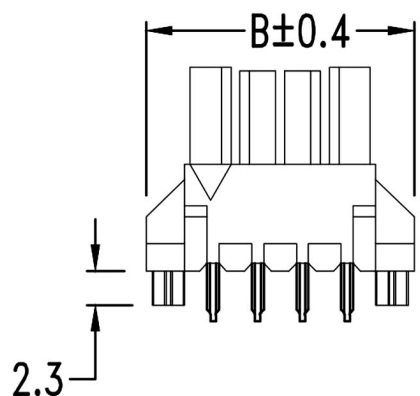
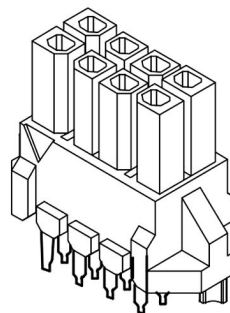
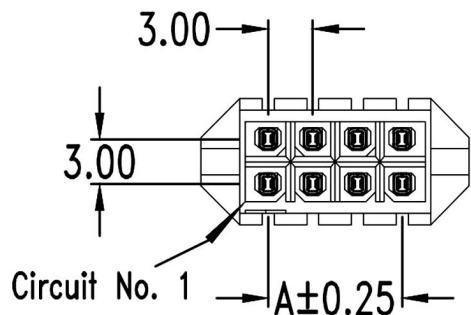

PCB Layout: Component side
Recommended PCB thickness: .062" (1.57mm)

Features:

- Available in 4–24 circuits
- Material: LCP UL 94-V0
- Pin material: Phosphor bronze
- Tin-plated
- Standard color: Black

Specifications:

- Voltage rating: 250V AC(RMS) or DC
- Current rating: 5A AC, DC
- Contact resistance: 10mΩ Max.
- Dielectric strength: 1500V AC/minute
- Ambient temperature range: -25°C ~ 85°C

RoHS
Compliant

HSM 玄茂科技股份有限公司
HSUAN MAO TECHNOLOGY CO., LTD.

APPD. 核准		TOLERANCE .000 ± 0.05 (mm)	PART NAME 品名
DWG. 製圖	SCALE 比例 參考	.00 ± 0.15 (mm)	Micro-Fit 3.0mm BMI Type 2XXXP
DATE 制表日	UNIT 單位 M M	.0 ± 0.25 (mm)	STRAIGHT TYPE WITH RETENTION PEG
2017/09/01	PAGE 張數 1 OF 1	SIZE: 紙張尺寸 A 4	TIN PLATING BLACK COLOR MATERIAL: LCP ROHS
		REV. 版次 A	PART NO. 料號 W4232-XXPSTB00R