

1 2 3 4 5 6 7 8

A  
B  
C  
D  
E  
F  
G  
H

A  
B  
C  
D  
E  
F  
G  
H

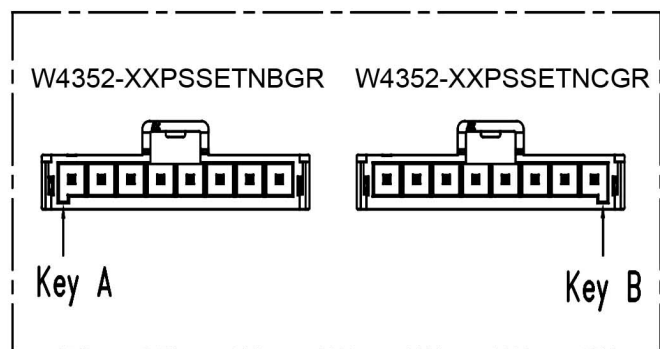
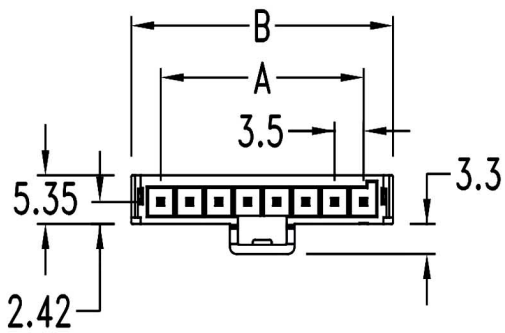

**Features:**

- 2 ~ 8 circuits available
- Plastic material: LCP
- ⚠ Pin material: High conductivity copper alloy
- ⚠ Finished: Tin-plated 100u" over copper 50u"
- .025"(0.64mm) square pin

**Specification:**

- ⚠ Current rating: 14A at #16 AWG for 2 poles  
8A at #16 AWG for other poles
- Voltage rating: 400V AC(RMS) or 400V DC Max.
- Contact resistance: 10mΩ Max.
- Dielectric withstanding voltage: 1800V AC/minute
- Ambient temperature range: -40°C ~ 105°C

**Ordering Information**

Part No.	Feature	Type	Color
W4352-XXPSSETNBGR	With retention clip	Key A	Black
W4352-XXPSSETNCGR		Key B	Natural

&& xx = 02 ~ 08

**Dimensional Information ( mm )**

Circuits	Dim. A	Dim. B	Dim. C
2	3.500	10.60	8.50
3	7.00	14.10	12.00
4	10.50	17.6	15.5
5	14.00	21.1	19.0
6	17.5	24.6	22.5
7	21.0	28.1	26.0
8	24.5	31.6	29.5

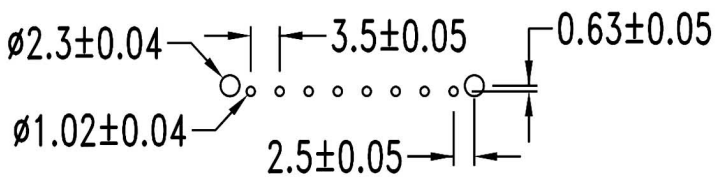
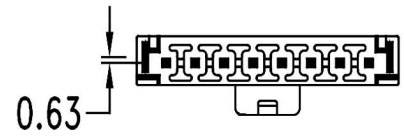
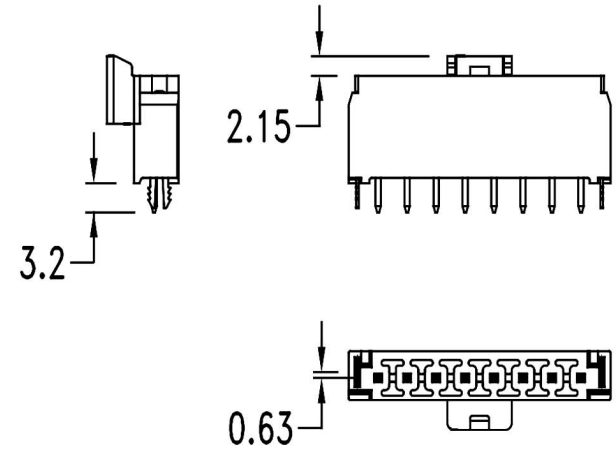
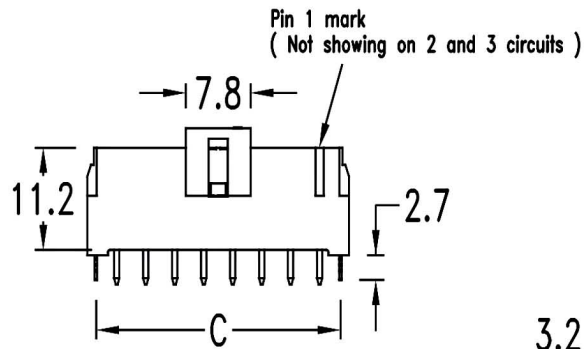

Recommended P. C. board layout

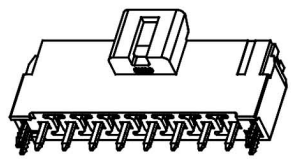

RoHS  
Compliant

**HSM** 玄茂科技股份有限公司  
**HSUAN MAO TECHNOLOGY CO., LTD.**

APPD. 核准  
DWG. 製圖  
DATE 制表日  
2020/01/14

SCALE 比例 參考  
UNIT 單位 M M  
PAGE 張數 1 OF 1

UNLESS OTHERWISE SPECIFIED TOLERANCE  
.000 ± 0.15 ( mm )  
.00 ± 0.25 ( mm )  
.0 ± 0.4 ( mm )  
SIZE 紙張尺寸 A 4  
REV. 版次 A

PART NAME 品名  
3.5mm Wafer Single Row 1XXXPin 180°  
With Retention Clip Tin Plating  
Material:LCP Bag Packing ROHS

PART NO.  
料號 W4352-XXPSSETNXGR

1 2 3 4 5 6 7 8